

# Floor Plans & Capacity Charts

## Pier 5 Hotel

Function Room	Square Footage	HT	Dimensions	Classroom Style	U-Shape	Conference Style	Theatre Style	Rounds	Rounds with Dance Floor	Stand-Up Reception
Harbor West	2880	15	81'x34'	160	-	-	300	210	170	300
A	952	15	28'x34'	45	25	25	90	60	-	95
B	1050	15	25'x42'	50	30	30	100	80	-	100
C	952	15	28'x34'	45	25	25	90	60	-	95
Harbor East	2363	15	40'x52'	120	40	45	230	160	120	250
D	1181	15	26'x40'	55	20	25	100	70	-	150
E	1181	15	26'x40'	55	20	25	100	70	-	150
Harbor Club	1910	9	42'x55'	120	45	45	250	200	150	275
Pier 5 Office	150	-	15'x10'	-	-	6	-	-	-	-

\*Please note, this is total capacity & does not consider staging, risers, or audio visual.

## Inn at Henderson's Wharf

Function Room	Square Footage	Dimensions	Classroom Style	U-Shape	Conference Style	Theatre Style	Rounds	Rounds with Dance Floor	Stand-Up Reception
McClintock	660	22'x30'	40	30	25	60	40	-	50
The Gallery	1530	17'x90'	80	50	40	40	120	80	125
Inn at Henderson's Wharf Office	208	16'x13'	-	-	8	-	-	-	-

\*Ceiling height for both rooms is 10 feet. \*Please note, this is total capacity & does not consider staging, risers, or audio visual.

## Admiral Fell Inn

Function Room	Square Footage	HT	Dimensions	Classroom Style	Conference Style	Theatre Style	Tables 8/10	Stand-Up Reception
Admiral's Room	1560	9	52'x30'	96	52	156	96/120	180
Admiral 1	780	9	26'x30'	36	36	66	48/60	90
Admiral 2	780	9	26'x30'	36	30	66	48/60	90
Captain's Room	540	9	24'3"x22"	24	20	34	32/40	50
Board Room	300	9	22'x13'6"	-	12	-	10/14	12
Bridge	380	9	23'7"x16"	-	18	-	24/30	40
Balconies	520	-	16'x33'	-	-	-	-	65
Total 5th Floor	2480	9	-	-	-	-	120/150	250
The Stone Parlor	438	8	17'x22'+	20	20	50	40	60
The Stone Room	759	8	33'x23'	30	30	60	60	80
Admiral Fell Inn Office	169	-	13'x13'	-	6	-	-	-

\*Please note, this is total capacity & does not consider staging, risers, or audio visual.

## Outdoor Venues Capacity Chart

Outdoor Venues	Square Footage	Dimensions	Theatre Style	Rounds	Rounds with Dance Floor	Stand-Up Reception
Pier 5 Harbor West Terrace	1750	25'x70'	180	140	100 (16x20 Floor)	200
Waterfront Garden at Pier 5 Hotel	2800	40'x70'	300	230	200 (16x16 Floor)	320
Bond Street Pier	1920	16'x120'	210	160	130 (16x16 Floor)	225
Bond Street Landing	3900/2250	30'x130'/30'x75'	430/250	320/180	290 (20x20 Floor)	450 275
Henderson's Pier	8824	20'x390'/16'x64'	900	580	560 (20x20 Floor)	980
Henderson's Marina Park	4800	40'x120'	525	400	360 (20 x 20 Floor)	550

\*Please note, this is total capacity & does not consider staging, risers, or audio visual.

### Pier 5 Hotel

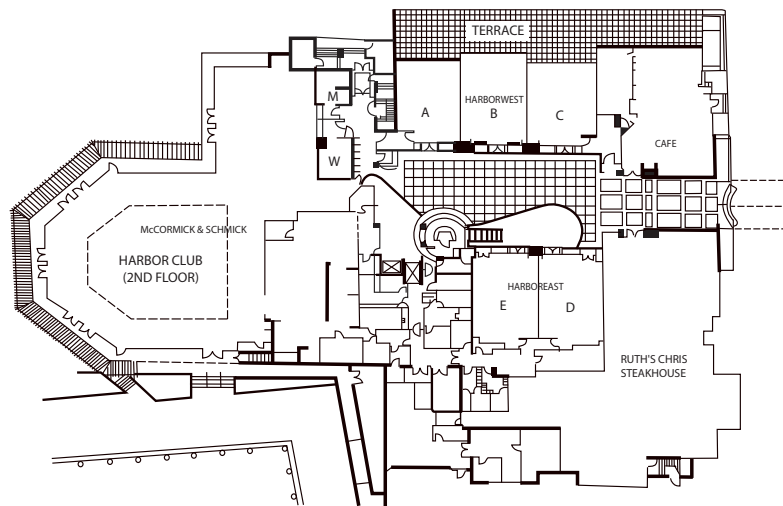

### Admiral Fell Inn

