

SEVENTH floor

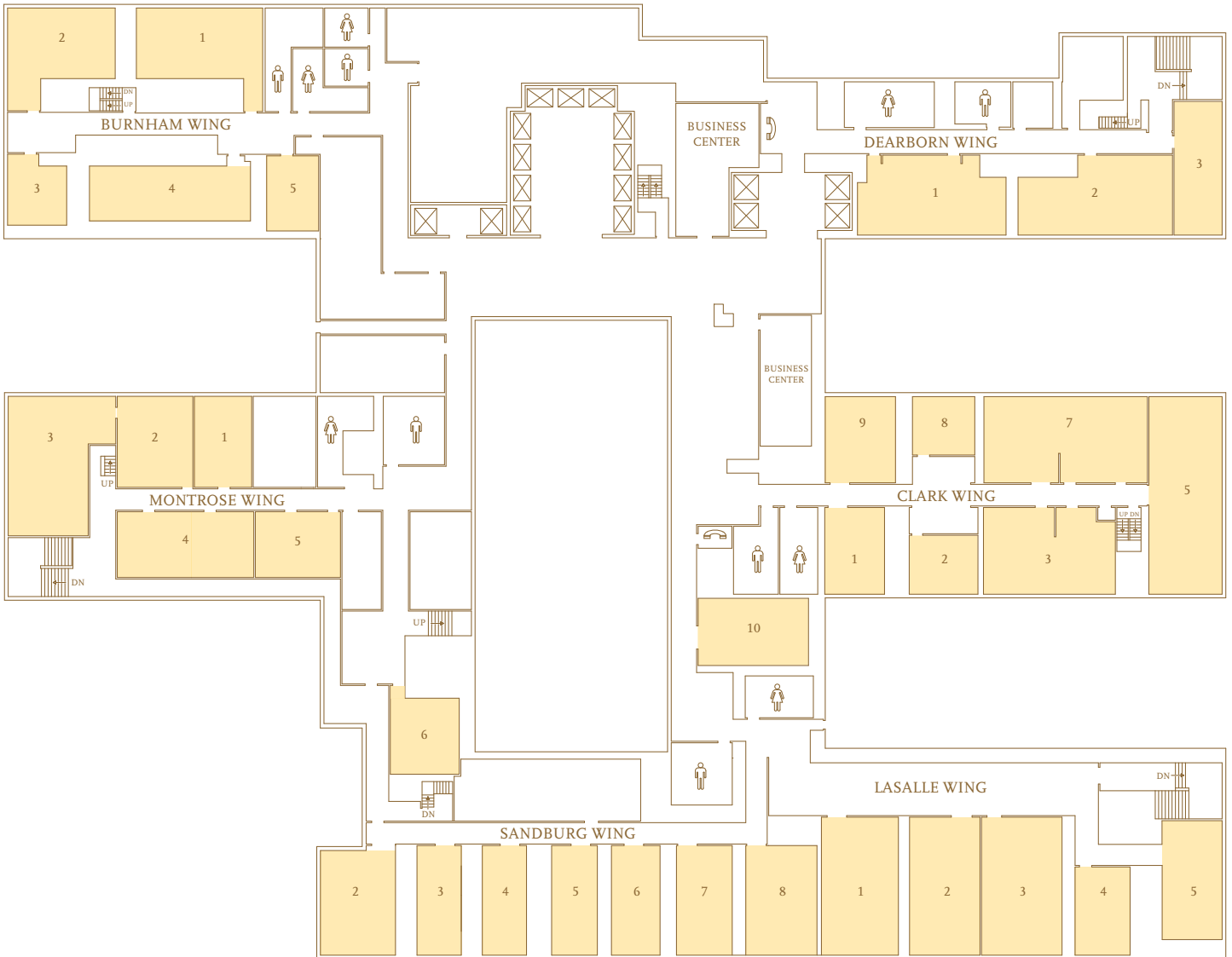

SEVENTH

floor
continued

Seventh Floor	Dimensions (l x w)	Square Feet ◊	Ceiling Height	Theater	Schoolroom 2/6'	Schoolroom 3/6'	Banquet	Reception •	Conference
Dearborn 1++	22' x 39'	714'	8'	50	24	36	40	67	30
Dearborn 2	20' x 30'	531'	8'	45	18	27	30	57	22
Dearborn 3++	17' x 33'	490'	8'	30	12	18	20	30	15
Clark 1	20' x 18'	346'	8'	30	12	18	20	36	18
Clark 2	14' x 17'	239'	8'	20	8	12	10	27	16
Clark 3	21' x 38'	663'	8'	40	16	24	40	48	24
Clark 5	28' x 48'	1,039'	8'	80	30	45	50	103	36
Clark 7	21' x 38'	729'	8'	50	20	30	50	70	24
Clark 8	13' x 16'	218'	8'	20	8	12	10	26	10
Clark 9	22' x 20'	416'	8'	35	12	18	30	50	16
Clark 10	30' x 17'	502'	8'	40	16	24	30	56	24
LaSalle 1	20' x 32'	672'	8'	50	24	36	50	72	28
LaSalle 2	35' x 21'	634'	8'	50	24	36	50	68	28
LaSalle 3	35' x 19'	628'	8'	50	24	36	50	68	28
LaSalle 4	16' x 21'	336'	8'	20	12	18	20	26	16
LaSalle 5++	16' x 34'	601'	8'	45	14	21	30	30	15
Sandburg 2	28' x 27'	523'	8'	N.A.	N.A.	N.A.	N.A.	N.A.	10
Sandburg 3	28' x 16'	358'	8'	N.A.	N.A.	N.A.	N.A.	N.A.	14
Sandburg 4	28' x 13'	373'	8'	N.A.	N.A.	N.A.	N.A.	N.A.	14
Sandburg 5	28' x 16'	398'	8'	N.A.	N.A.	N.A.	N.A.	N.A.	14
Sandburg 6	28' x 17'	378'	8'	N.A.	N.A.	N.A.	N.A.	N.A.	14
Sandburg 7	28' x 15'	381'	8'	N.A.	N.A.	N.A.	N.A.	N.A.	10
Sandburg 8	28' x 18'	474'	8'	N.A.	N.A.	N.A.	N.A.	N.A.	10
Montrose 1++	15' x 49'	735'	8'	20	8	12	10	15	12
Montrose 2	17' x 27'	459'	8'	20	8	12	10	15	12
Montrose 3	15' x 28'	420'	8'	30	14	21	30	30	16
Montrose 4	16' x 16'	256'	8'	30	16	24	30	30	24
Montrose 5	15' x 16'	240'	8'	30	16	24	30	30	24
Montrose 6	16' x 16'	256'	8'	25	16	24	20	30	18
Burnham 1++	25' x 33'	616'	8'	64	24	36	40	70	28
Burnham 2	26' x 30'	570'	8'	54	20	30	30	60	28
Burnham 3	19' x 17'	252'	8'	18	8	12	10	29	10
Burnham 4	18' x 47'	678'	8'	80	28	42	50	76	36
Burnham 5	19' x 19'	338'	8'	30	12	18	20	30	16

◊ Usable square footage

• Capacities take into consideration placement of bars, cocktail rounds, food stations, and experience of hotel

++ Indicates room equipped with built-in wet bar